



The Original

Safe drinking water
Anywhere. Anytime.



Hydro-Photon, Inc.
PO Box 675
262 Ellsworth Road
Blue Hill, ME 04614 USA
Toll Free USA: 1-888-SteriPEN
(+1) 207-374-5800
info@steripen.com
www.steripen.com

SPPF.UG.1210

©2013 Hydro-Photon, Inc.

The best-selling portable UV purifier

Thanks for choosing the SteriPEN Classic and congratulations on your purchase!

Classic is built to be safe, simple and straightforward. If, after reading this guide, you have any questions please don't hesitate to call us at 1-888-826-6234. We love hearing from you!

Also, be sure to visit us online and register your Classic for all the latest news and special deals.

Thanks again and happy travels from your friends at SteriPEN!

P.S. Don't forget to recycle the packaging!



www.steripen.com
facebook.com/steripen
@steripen

Classic's Anatomy

- 1) Lamp cover
- 2) UV lamp
- 3) Water sensor pins
- 4) Activation button
- 5) Indicator LED
- 6) Battery cap

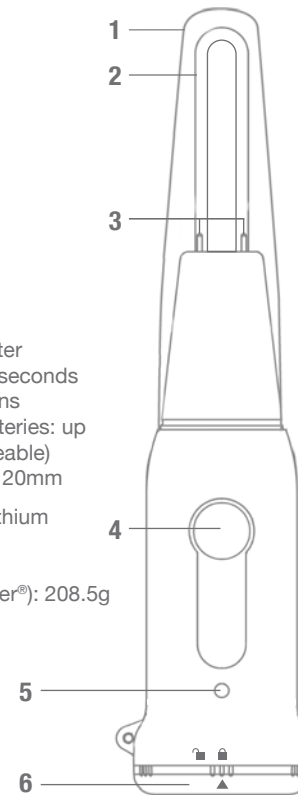

Specifications

Treatment size: 0.5 or 1 liter
Treatment time: 48 or 90 seconds
Lamp life: 8,000 activations
Treatments per set of batteries: up to 100 (80 with rechargeable)
Minimum bottle opening: 20mm
Weight with disposable lithium batteries: 156g
Weight with rechargeable NiMH batteries (Energizer®): 208.5g
193 x 38 x 38mm

Pre-Filter's Anatomy

- 1) Air vent (not for drinking)
- 2) Filter cartridge
- 3) Pre-Filter base
- 4) Bottle gasket

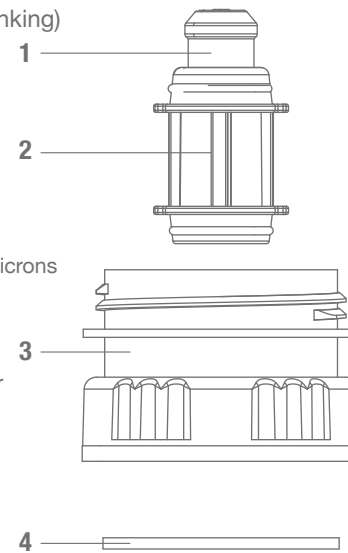

Specifications

Nominal filter size: 40 microns
Weight: 45g
47.5 x 67.9mm diameter

Pre-Filter removes large particles, such as leaves, twigs, sand and other debris for improved effectiveness of UV purification. It is not intended as a purification method.

To store Pre-Filter, insert filter cartridge with air vent pointing down and rotate clockwise to lock in place.

Fits most wide-mouthed bottles, like Nalgene®.

Easy to Use

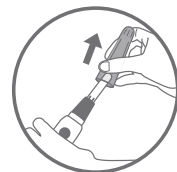

Step 1
Remove lamp cover.
Pull away from the lamp. Take care not to wet Classic's water sensor pins before activating.



Step 2
Press activation button.
1x for 1 liter treatment, 2x for 0.5 liter treatment. LED will flash green for 15 seconds to indicate unit is armed.

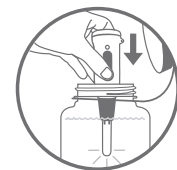

Step 3
Submerge and stir.
When water sensor pins detect water, lamp will illuminate until treatment is complete.

When lamp turns off, LED indicator will display treatment success or failure (see "Classic LED Indicator Guide section").

Be sure to wipe bottle threads dry before drinking.

Battery Guide



Remove battery cap by rotating counterclockwise so that cap arrow points to open lock icon.



Install AA batteries with polarities as shown in battery compartment.



Replace battery cap by aligning cap with open lock icon. Then, rotate cap clockwise until arrow points to closed lock icon.

Classic runs on disposable **lithium** batteries or **rechargeable nickel metal hydride (NiMH) AA** batteries with a 2300mAh capacity. **DO NOT USE ALKALINE BATTERIES.**

For best results, always use quality, name brand batteries, like Energizer® or Sanyo Eneloop®.

Classic LED Indicator Guide

LED Color & Pattern	Indication
Operating Signals	
	Armed, ready for treatment.
	1 L Treatment successful!
	0.5 L Treatment successful!
	Treatment activation timed out. Press button to re-activate.
	Wet sensors. Dry water sensors and re-activate.
	Treatment incomplete. Classic lost detection of the water. <i>Treat again before consuming.</i>
Battery Warnings	
	Dead battery.
	1L treatment successful but battery is low.
	0.5L treatment successful but battery is low.
	No signal. Check or recharge batteries.
Lamp Warnings	
	< 100 treatments remaining.
	Lamp failure.

If LED indicators show normal signals, but lamp does not activate, lamp has failed. Do not consume.

Tips for Safe Use

- When operating properly, the UV lamp will emit visible light as well as UV light. If the lamp is not emitting visible light, it is not functioning properly and should not be used until it has been repaired.
- Agitation of water by stirring Classic or rocking the container is necessary, as it promotes uniform purification.
- Classic is not intended to disinfect water above the surface of the water in the container, such as droplets on the sides of the container.
- Classic is not intended to disinfect surfaces of a drinking container, like the mouth of the bottle. Be certain that you *always wipe the bottle's mouth dry with a clean, dry cloth before drinking.*
- Classic is intended for use, and is most effective in clear water but can also be used to treat turbid, murky or cloudy water in an emergency. By doubling treatment time (treating the volume of water twice), Classic can treat water that might be described as: *"much closer to clear than opaque," "obviously not clear," "obviously cloudy," "objects viewed through the water are visible but blurry," or "as cloudy as weak lemonade."* If the water is less clear, filter it first with the SteriPEN® PreFilter, FitsAll Filter® or other method for best UV purification results.
- Classic may be used in glass, plastic, ceramic or metal containers, as they all absorb or reflect UV light, thereby shielding the user from UV exposure.
- Classic is not intended for use by children.
- Classic is a high voltage device. Removal or tampering with the electronic circuit board or lamp assembly may cause injury, or damage.
- Do not open, expose, modify or touch internal circuitry; doing so can lead to high voltage shock.
- Do not attempt to bypass water sensor; it is an important safety feature.
- As with other fluorescent-type lamps, Classic contains a small amount of mercury. At the end of its life, please dispose of Classic properly. For specific instructions contact your local waste disposal organization.
- Classic is not intended to treat liquids other than water.
- Do not use UV lamp as a light source.
- Do not use near skin, eyes or insert into bodily orifices.
- Do not use in water above 120°F/49°C.
- Do not use in water with ice.
- As with any other water treatment system, always have a backup method.
- While carefully controlled microbiological testing of all SteriPEN products has been conducted, use of all SteriPEN products in the field may produce results that vary from our laboratory test data.
- Do not use in any manner other than instructed in this User's Guide.

Care & Cleaning

While Classic's battery compartment is designed to be highly water-resistant, it is not *waterproof*. Avoid submerging Classic's battery end in water.

Classic's performance may be adversely affected by cold weather. In temperatures below 32°F/0°C carry the unit close to your body or warm up batteries before use. If batteries are too cold, Classic's LED indicator may give low battery signal. Warm up batteries and treat again.

Make sure to wipe dry after each use.

When not in use, Classic should be kept in a safe place that is clean and dry. It should not be exposed to temperatures above 120°F/49°C or below -4°F/-20°C. Also, when storing for long periods of time, remove batteries to keep them from inadvertently draining.

To clean Classic, wash with a soft cloth and a mild soap solution. Rinse soap from device and dry with a clean, soft cloth.

If Classic's bulb is cracked, chipped or damaged, don't use it. Return it to the store or contact us for repair. Email us at support@steripen.com or call us at 1-888-826-6234 for help. *Do not try to fix it yourself.*

Using the Pre-Filter



Step 1
Screw Pre-Filter onto bottle.
Insert cartridge and pull blue air vent open.



Step 2
Filter water.
Pour through or submerge bottle until filled.



Step 3
Remove cartridge and purify.
Activate Classic, then insert into Pre-Filter and invert bottle.

For best results, wet filter cartridge before filling to improve water flow. Rub the mesh with a clean cloth until it becomes thoroughly saturated.

Remove Pre-Filter before drinking.

Air vent is not intended for use as a mouthpiece.

Classic does not treat water droplets on the Pre-Filter's body or threads. Be sure to wipe dry any wet surfaces before drinking.

Frequently Asked Questions

Get in touch! We are always happy to hear from you: visit www.steripen.com, email info@steripen.com or call 1-888-826-6234.

How many treatments can I expect to get?

*With disposable lithium batteries you can expect around 100 full-liter treatments. NiMH rechargeable batteries with 2300mAh capacity will provide around 80 full-liter treatments. Be sure to always use quality batteries and **never use alkaline batteries.***

It looks like the tip of Classic's lamp is melting – is this normal?

What you are seeing is a small bead of silicone used as a shock absorber to protect the lamp.

What happens when I've used Classic 8,000 times?

Classic's LED indicator will flash red three times then green once to indicate that its bulb is exhausted. Contact us to have it replaced.

Classic's bulb is shining a purple, rather than blue light - is it still working?

Yes. The visible light indicates that the bulb is working regardless of its color.

Can I take Classic on a plane?

Yes. Classic and all SteriPEN products are allowed in carry-on bags, as well as checked luggage. Classic will work in any country to destroy bacteria, viruses and protozoa.

Does altitude affect Classic's ability to purify water?

No. SteriPEN technology and product design have been tested and used on Mount Everest for years.

Can I use Classic to treat more than 1 liter at a time?

No, we do not recommend it. Classic's effectiveness is ONLY tested and certified for volumes up to 1 liter. You can, however treat and combine multiple 1-liter volumes of water.

What about parasites like worms and their eggs? Does Classic treat for them?

Due to animal testing restrictions, Classic's effectiveness against such parasites has not been certified.

Can Classic treat soda? Iced tea? Juice?

No. UV light may not effectively destroy microbes in beverages other than water.

Patented & Certified

SteriPEN® technology is patented in the USA with further U.S. patents pending and patents pending worldwide. SteriPEN® is a registered trademark of Hydro-Photon, Inc. U.S. Patent Numbers 5,900,212 & 6,110,424 & 6,579,495.

Compliance testing of SteriPEN Classic for the CE mark and ETL logo was successfully completed by Intertek.

Conforms to: IEC 61010-1:2001 (2nd Ed), EN 61010-1:2001 (2nd Ed), including deviations to CAN/CSA C22.2 No. 61010-01-04 and UL 60950-1:2004 (2nd Ed.)



Water Quality Association:
SteriPEN® tested and Gold Seal certified by WQA against U.S. EPA Microbiological Water Purifier Standard.

The Fine Print

Directions for Use 40 C.F.R. §156.10(i)(2)

It is a violation of Federal law to use this product in a manner inconsistent with its labeling.

40 C.F.R. §156.10(i)(2)(ii)

SteriPEN® exceeds U.S. EPA Guide Standard and Protocol for Testing Microbiological Water Purifiers, destroying over 99.9999% of bacteria, 99.99% of viruses, and 99.9% of protozoa when used as directed. SteriPEN® is not a sterilizer.

Limited Lifetime Warranty for any manufacturing defect. For product registration and complete warranty information, please visit www.steripen.com/warranty or contact your local distributor.

While carefully controlled microbiological testing of Classic has been conducted, use in the field may produce results that vary from our laboratory test data.

This Class B digital apparatus complies with Canadian ICES-003. Cet appareil numérique de la classe B est conforme à la norme NMB-003 du Canada.

NOTE: This equipment has been tested and found to comply with the limits for a Class B digital device, pursuant to Part 15 of the FCC Rules. These limits are designed to provide reasonable protection against harmful interference in a residential installation. This equipment generates, uses and can radiate radio frequency energy and, if not installed and used in accordance with the instructions, may cause harmful interference to radio communications. However, there is no guarantee that interference will not occur in a particular installation. If this equipment does cause harmful interference to radio or television reception, which can be determined by turning the equipment off and on, the user is encouraged to try to correct the interference by one or more of the following measures:

- Reorient or relocate the receiving antenna.
- Increase the separation between the equipment and receiver.
- Connect the equipment into an outlet on a circuit different from that to which the receiver is connected.
- Consult the dealer or an experienced radio/TV technician for help.

Warning: Changes or modifications to this unit not expressly approved by the party responsible for compliance could void the user authority to operate the equipment under FCC rules.

